

FLOATLESS SWITCH

KFS-PC8(8PIN) KFS-PC11(11PIN)



FEATURES

- Automatic control of water level
- Small size and easy mounting
- Secondary voltage between electrodes : AC 8V

SPECIFICATIONS

Model No.	KFS-PC8	KFS-PC11
Rated Voltage	100 110VAC 200 220VAC (50/60Hz)	100 110VAC 200 220VAC (50/60Hz)
Operating Indicator	Red LED	
Wire Connection(Socket)	KH-TDR-R8	KH-TDR-R11
Power Consumption	Max. 3.2VA	
Operating Voltage	Max. ± 10% of Rated Voltage	
2nd Voltage between electrodes	AC 8V (2nd voltage)	
Operate Resistance	Max. 4 KΩ	
Release Resistance	Min. 15 KΩ	
Relay Operating Time	Operate : Max. 80mSec actibating Release : Max. 160mSec deactibating	
Output Contact Rating	220VAC, 2.5A at resistive load	
Life	Mechanical : Min. 5,000,000 operations Electrical : Min. 200,000 operations	
Insulation Resistance	Min. 100 MΩ at 500VDC	
Dielectric Strength	1,000VAC (50/60Hz) for 1 minute	
Ambient Temperature	- 10 +50 (at not freezing)	
Storage Temperature	- 20 +55 (at not freezing)	
Vibration Resistance	10-55 Hz at double amplitude of 1.0 mm (X,Y,Z directions)	
Shock Resistance	Approx. 30G(300 m/s ²)	
Ambient Humidity	35 85% RH	
Protection	IP 50 (Indoor use only)	
Material	ABS	
Weight	Approx. 230g	

FLOATLESS SWITCH

INTERNAL CIRCUIT CONNECTION

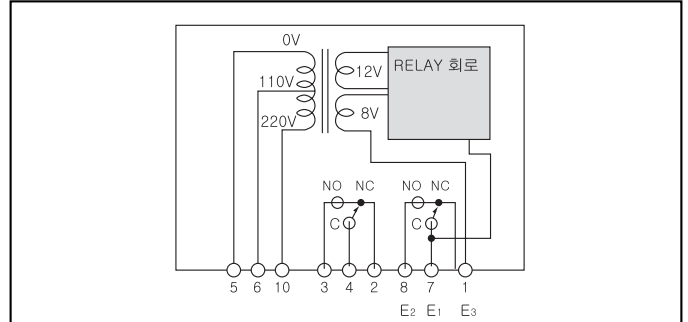
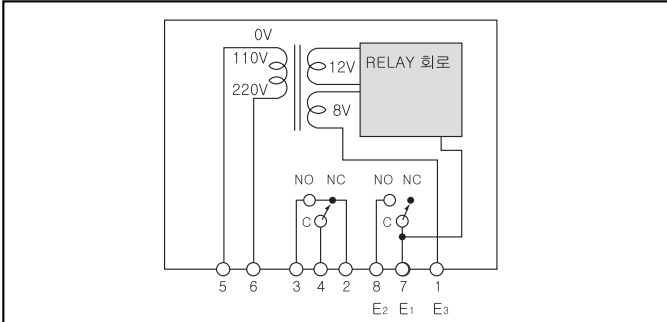

CONNECTIONS

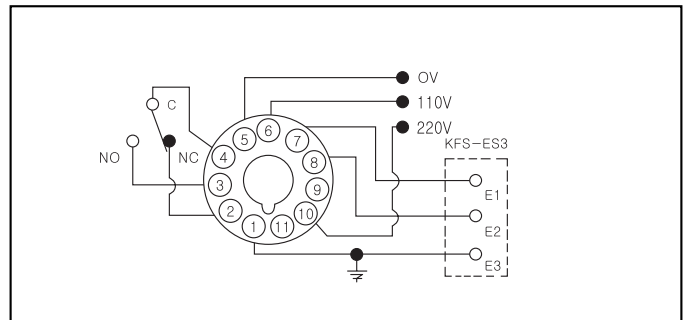
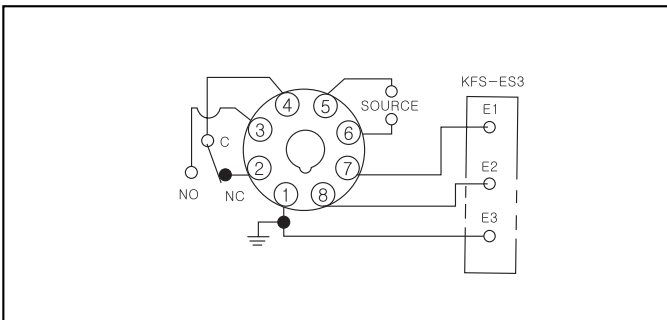

PRECAUTION FOR OPERATIONS

1. Apply the rated voltage
2. The surface of electrode should be cleaned up at least every 6 months
3. Electrode fixing coupler must be used in order to maintain the distance among the electrodes.
4. Do not use this product on the purpose of oil level control.

DIMENSIONS

KFS-PC8(8Pin)
KFS-PC11(11Pin)

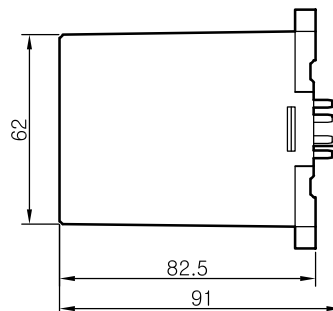
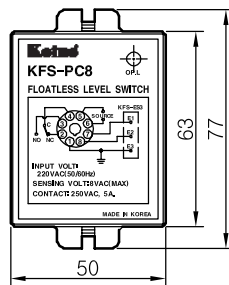

FLOATLESS SWITCH

KFS-PC8(8PIN) OPERATION MODE

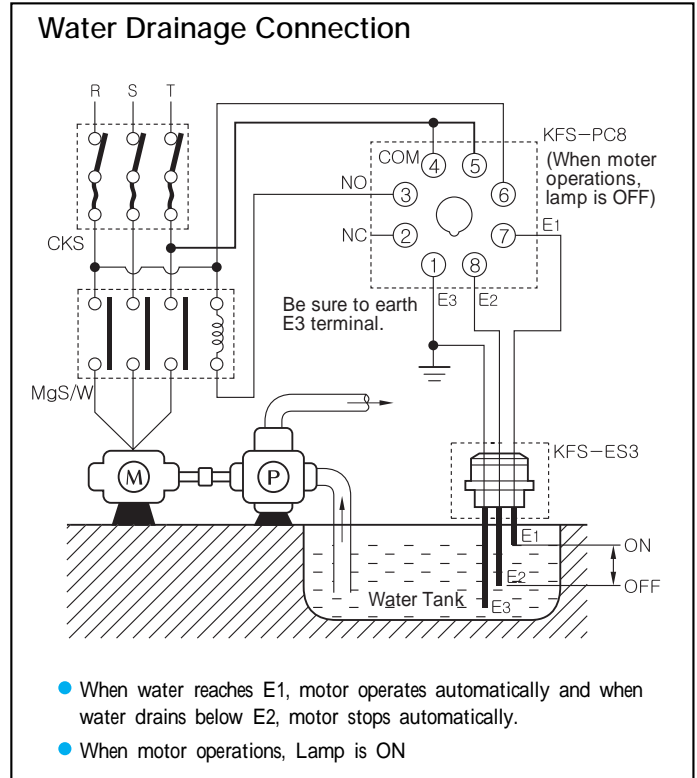
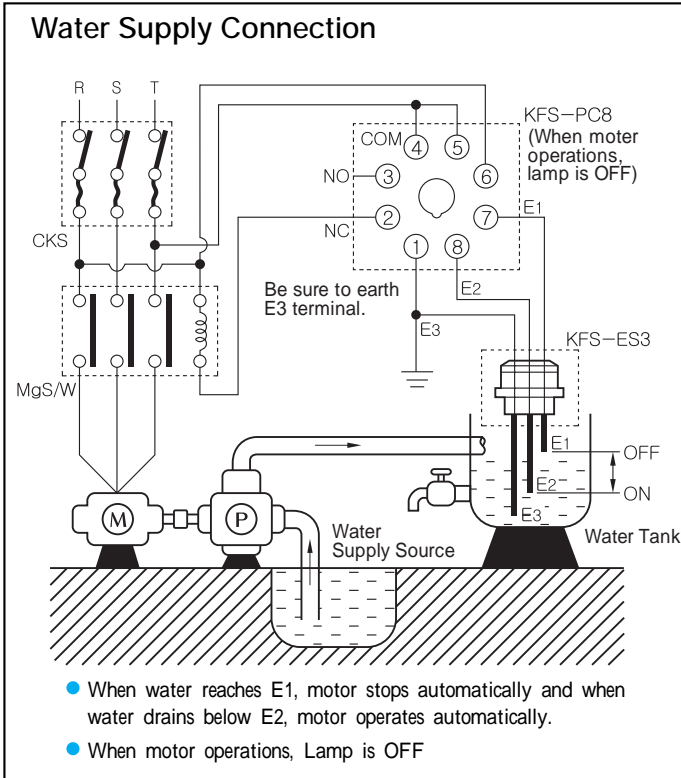

KFS-PC11(11PIN) OPERATION MODE

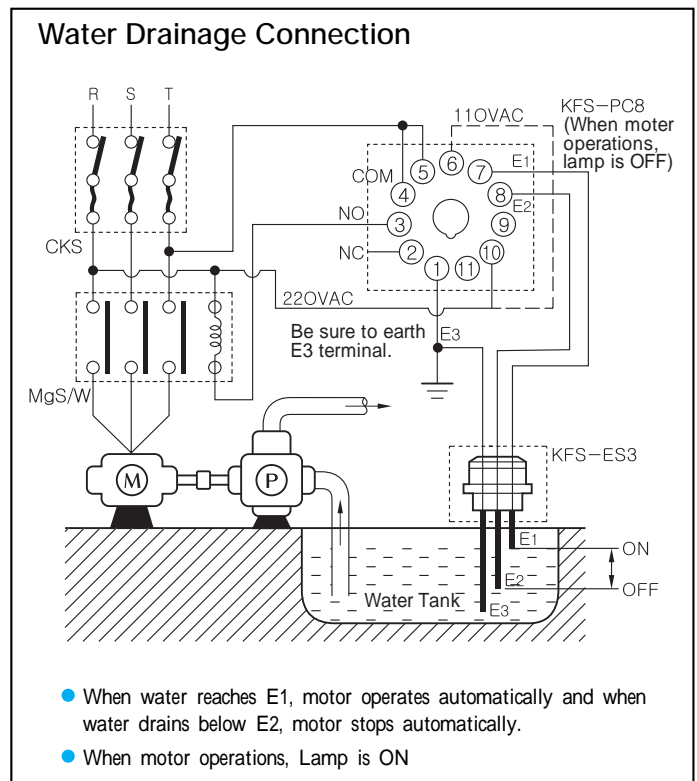
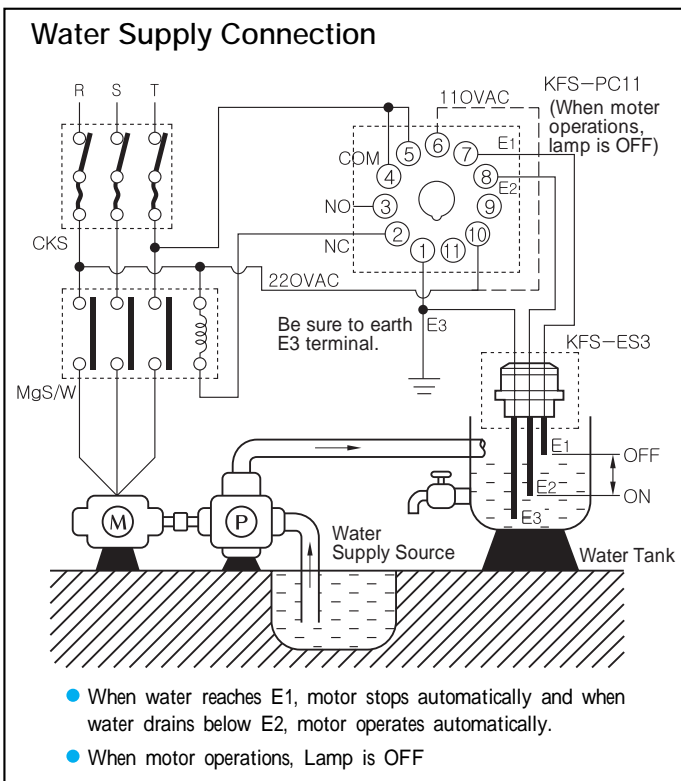

FLOATLESS ELECTRODE FIXING COUPLER



FEATURES

- Rigid phenol resin body
- Electrode fixing coupler material of Brass(Bs) Plating Nickel(Ni)
- Electrode bar type : 3-M6P1 material of copper(Cu) bar or brass(Bs) bar
- wire connection : Screws on the terminal board
- Protection : IP 63

DIMENSIONS

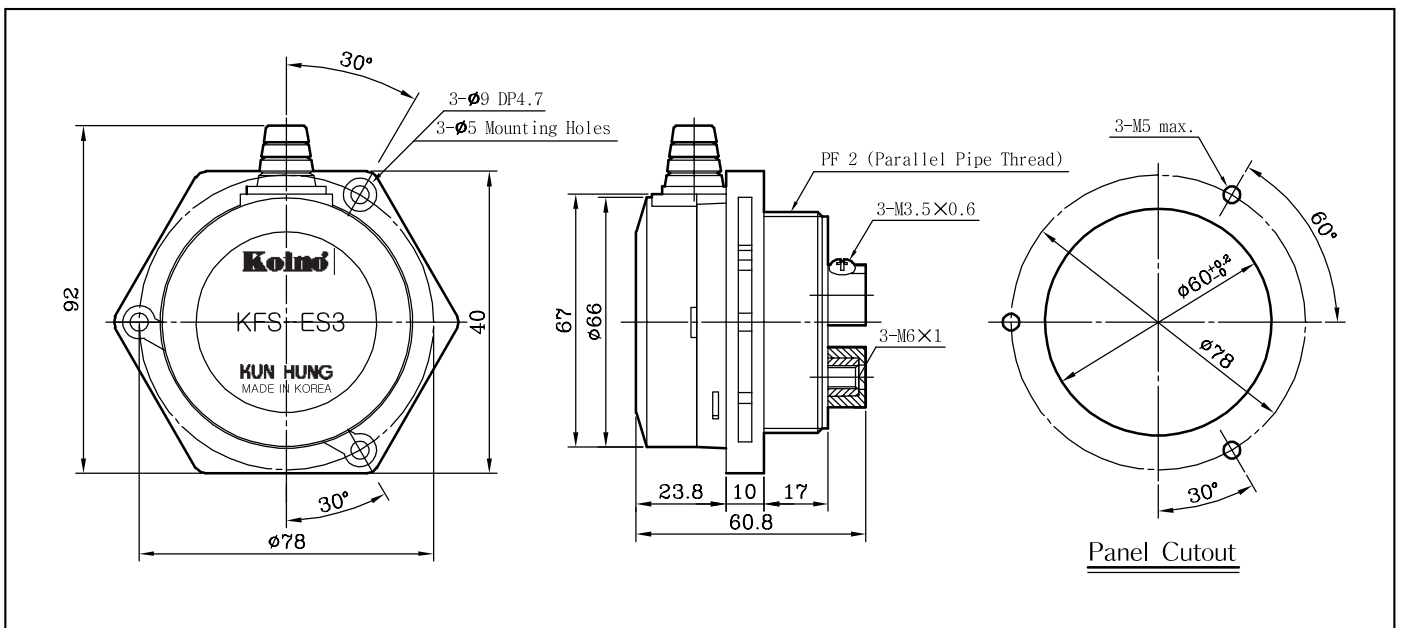

TEMPERATURE CONTROLLER

MODEL CLASSIFICATION METHOD

KET - 2 48 D

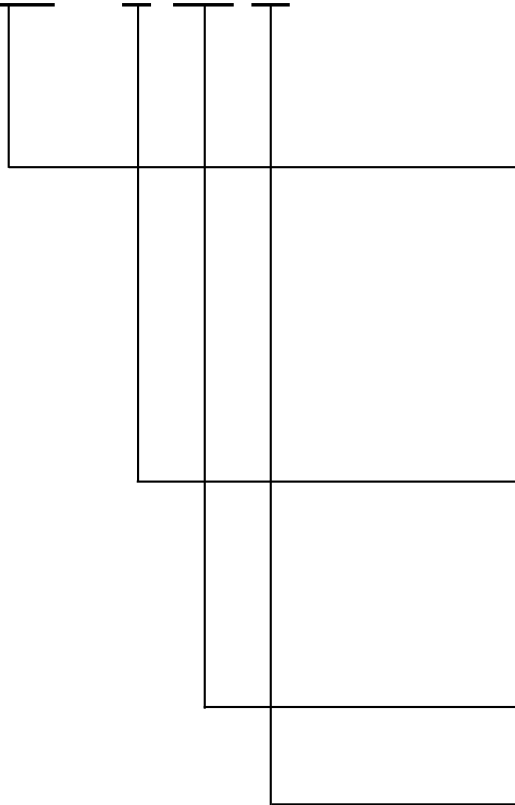

Classification	Symbol	Contents
Company & Type	K	Koino KUN HUNG
	ET	Temperature Controller
Temperature Scale Range	1	0 100 (KET - 148)
	2	0 200 (KET - 248)
		0 199 (KET - 248D)
	3	0 300 (KET - 348)
		0 299 (KET - 348D)
	4	0 400 (KET - 448)
0 399 (KET - 448D)		
6	0 600 (KET - 648)	
	0 599 (KET - 648D)	
10	0 999 (KET - 1048D)	
Size	48	DIN Size(48 mm × 48 mm)
Indication	Non	No Indication Temperature Controller
	D	Digital Indication Temperature Controller
	DA	48 Digital Temperature Controller (proportional control type)